

 Fichet Bauche®

Complice Style

Safe + Special Interior Fittings
Certified Fire &
Burglary Protection



Limited edition



Certified
fire
resistance



Certified
burglary
resistance



www.fichet-bauché.com

COMPLICE STYLE

Certified Fire & Burglary Protection

- ✦ Burglary resistance as per EN 1143-1 certified by A2P (Grade 0)
- ✦ Fire resistance as per EN 15659 certified by ECB-S (Grade LFS 30 P, i.e. 30 minutes for paper documents)
 - 2 sizes available: 20 or 40 litres
 - MpX key lock +3 combination cylinders

Clever fittings for more ease of use!



Removable drawers to deposit/withdraw jewellery items with ease Glass shelf allowing for quick visual identification of contents



Standard drawer and special drawer with bars for rings and earrings



Automatic LED lighting



Magnetic plate to access ID labels and cylinders

Fichet-Bauche guarantees

Our products are subjected to the most stringent tests approved by insurers and A2P-certified by France's National Centre for Prevention and Protection (CNPP). This is the result of integrating our own test laboratory into our factory to impose conditions going even further than those of certifying bodies. Installation is also carried out by our own technicians to ensure certification of your safe is always preserved.

Stylish modern design **blending in with your office or bedroom**

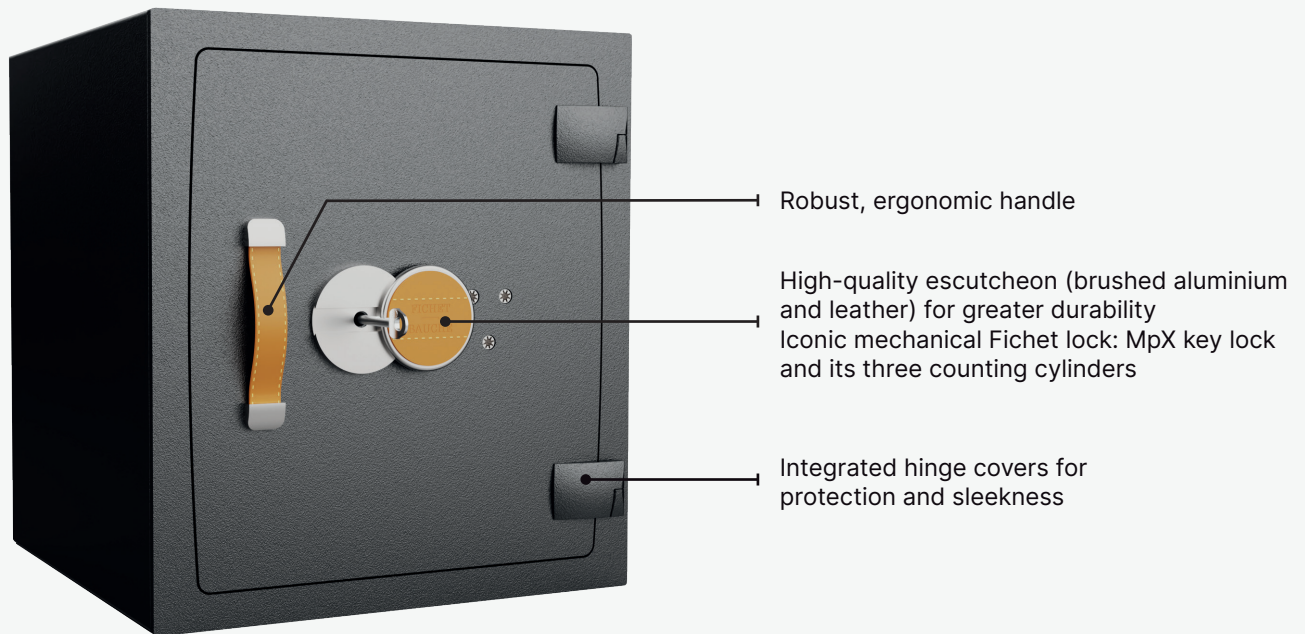

Tried-and-tested Fichet-Bauche solutions and **premium materials for high quality and durability**

Composite barrier material developed by our R&D teams

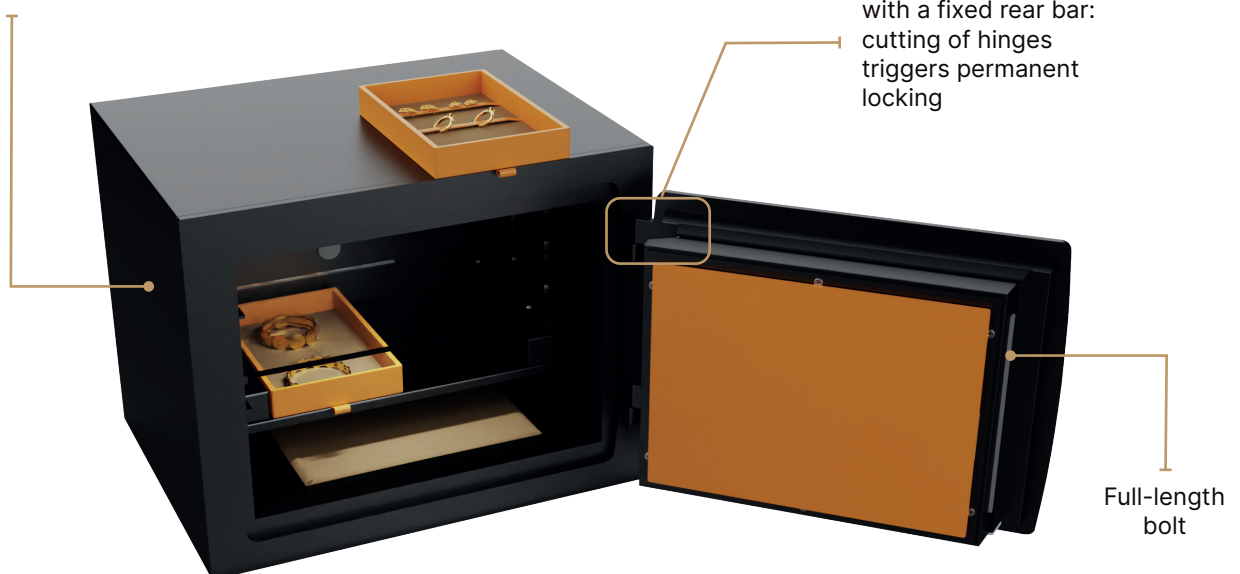



Complice Style 20



Complice Style 40

Technical specifications

Models		Complice Style 20	Complice Style 40
Capacity (Litres)		20	43
External Dimensions (mm)	Height	360	500
	Width	455	455
Hinges projection not included	Total width with door open to 180°	841	841
	Depth (without handle & locks)	356	436
	Total depth with door open to 90°	769	849
Weight (kg)		60	89

Fichet's iconic lock: MpX key lock +3 counting cylinders



MpX mechanical key lock +3 cylinders

With 200 years of experience as master locksmiths, we develop and manufacture our own exclusive locks. This is one of the key strengths of our safes and a guarantee of high security. We remain committed to permanent investment in R&D, always looking for more functionality, more resistance, new materials and more advanced lock technologies.

