

A Royal residence for Royal events



EN

❖❖❖ La Venaria Reale



RESIDENZE
REALI
SABAUDE



Leave commonplaces behind.
—— Step into history.

Whether you're holding an important press conference or a gala dinner, scouting for an original location or looking for the perfect site for a film set, a photo shoot or a mission-critical event, you have come to the right place.

Some 10 km from the city of Turin, immersed in an environmental and architectural setting of absolute beauty and magnificence, La Venaria Reale welcomes you and your guests in its grandiose architectural complex listed among the "World Heritage Sites" by UNESCO.

It is hard to believe that just a stone's throw from a big city, you can actually step into a new dimension of life, full of nature, art and history, all contributing to this superb spectacle.

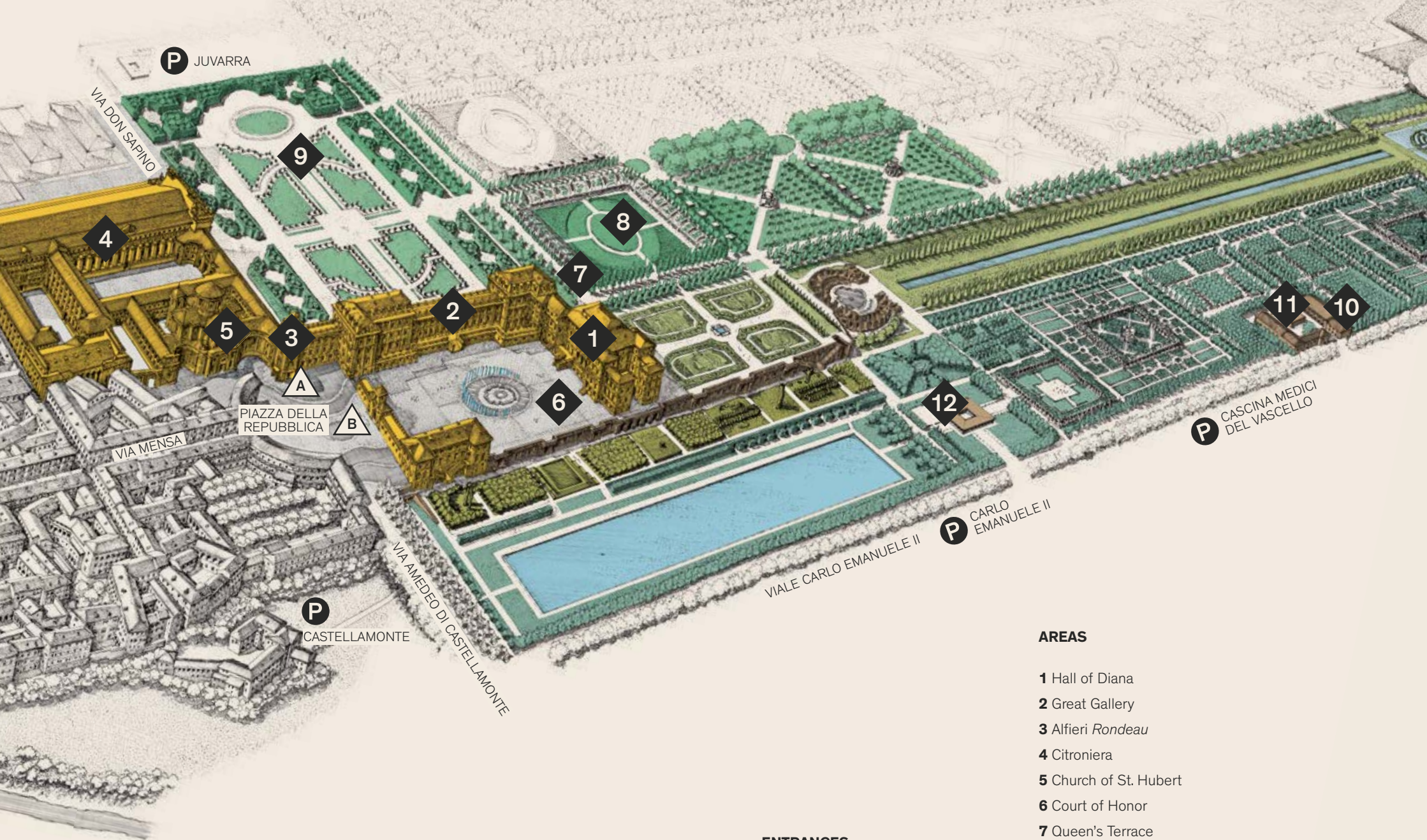

Yes, all of this is real. La Venaria has one more quality – it boasts a huge variety of settings for any type of event. Just choose the one that best suits your purpose and rest assured you will make a great impression.

An unforgettable place cannot but make everything unforgettable.



The estate

ENTRANCES

-  Reggia
Permanent Display
and Visitors Desk
-  Gardens
Rooms of the Arts, Reception,
Fountain of the Stag

AREAS

- 1** Hall of Diana
- 2** Great Gallery
- 3** Alfieri *Rondeau*
- 4** Citroniera
- 5** Church of St. Hubert
- 6** Court of Honor
- 7** Queen's Terrace
- 8** Rose Garden
- 9** Grand Parterre
- 10** Cascina Medici del Vascello (conference room)
- 11** Cascina Medici del Vascello (multipurpose room)
- 12** Patio dei Giardini

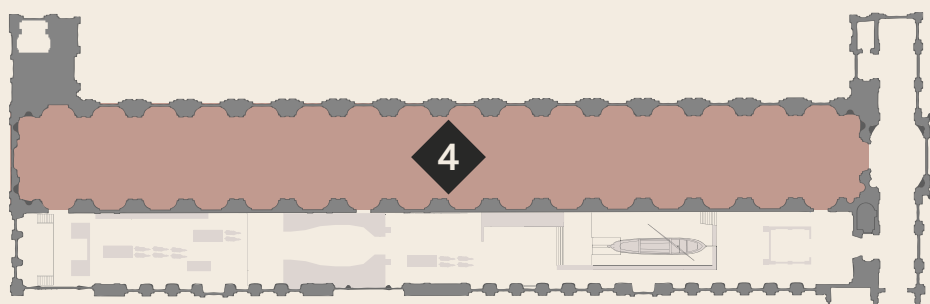
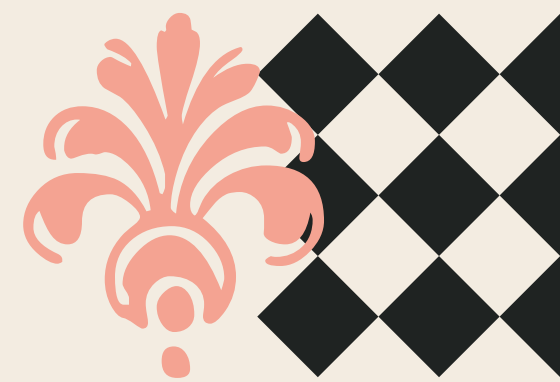

- 1 Hall of Diana
- 2 Great Gallery
- 3 Alfieri Rondeau
- 4 Citroniera
- 5 Church of St. Hubert

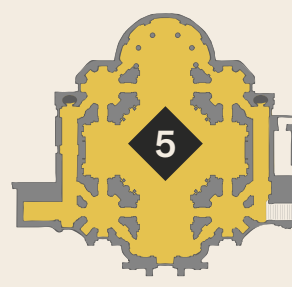

AREAS RESERVED FOR CATERING

Mezzanine: storage room and passageways
First floor: kitchens, cold rooms, storage rooms, bathrooms, changing rooms, passageways
Basement: food delivery



Reggia entrance

Gardens entrance

The Reggia

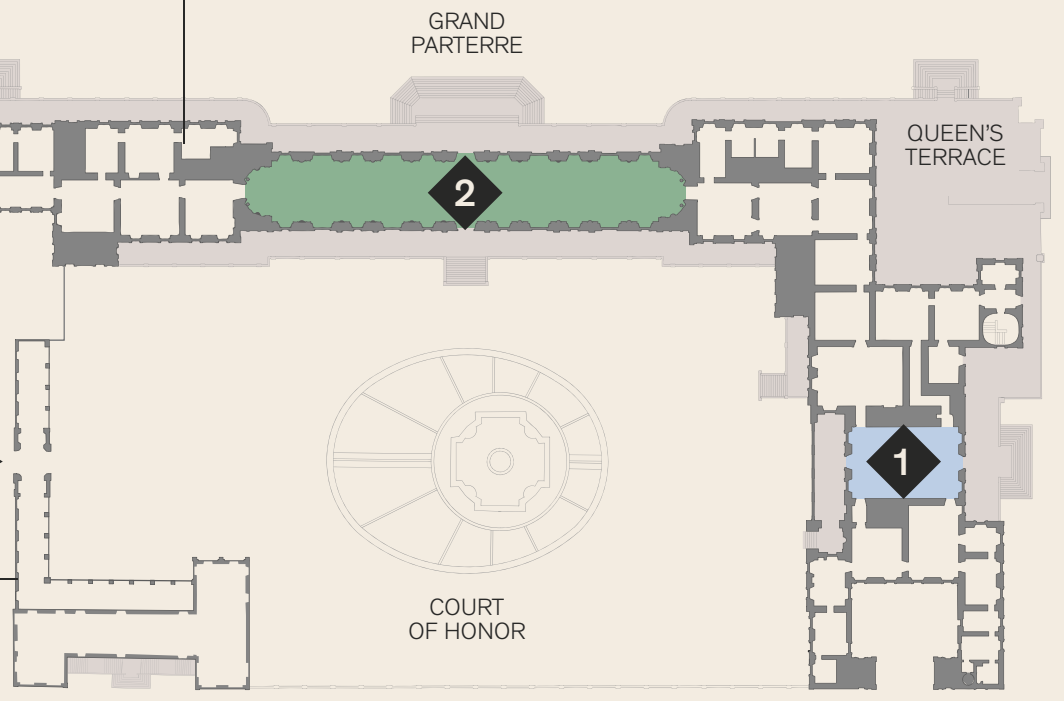

GRAND PARTERRE

QUEEN'S TERRACE

COURT OF HONOR

Hall of Diana

The heart of the 17th century Reggia, the hall used to accommodate memorable receptions and Court banquets. Still today, it keeps all its original charm.

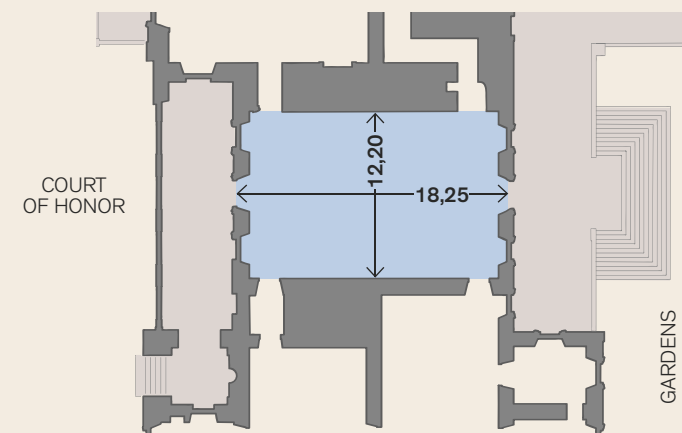

EVENTS presentations, conferences, concerts, shows, film sets, photo shoots, civil weddings

CAPACITY up to 120 seats

FACILITIES attended cloakroom in the basement

MAX POWER 6 kW, single-phase

Great Gallery

A triumph of light and decorations designed by Filippo Juvarra welcomes your guests in one of the most charming settings in the world.



EVENTS	aperitifs, gala dinners, concerts, shows, film sets and photo shoots
CAPACITY	up to 600 seats or 850 standing places
FACILITIES	equipped kitchen (on the first floor, with goods lift), attended cloakroom in the basement
MAX POWER	70 kW, three-phase

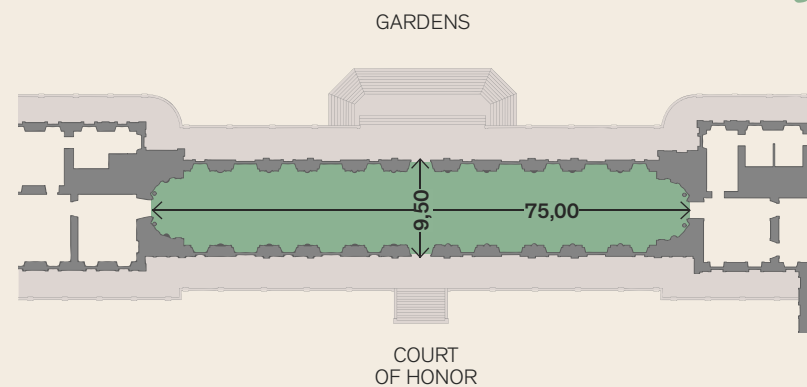

Alfieri

Rondeau

Designed by Benedetto Alfieri, the round hall housing the statues of the seasons acts as a junction in the grand ceremonial tour of the Reggia.



EVENTS aperitifs, gala dinners, concerts, shows, film sets and photo shoots

CAPACITY up to 180 seats or 350 standing places

FACILITIES equipped kitchen (on the first floor, with goods lift), attended cloakroom in the basement

MAX POWER 6 kW, single-phase

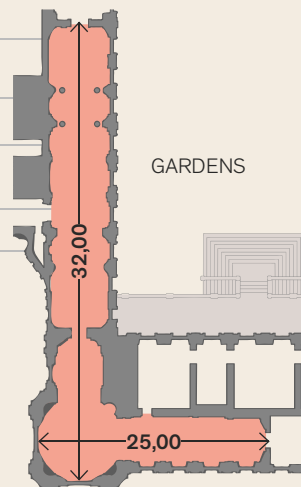

Citroniera

An imposing, elegant space ideal for large events — another masterpiece created by Filippo Juvarra.



EVENTS aperitifs, gala dinners, concerts, shows, film sets, photo shoots, presentations and conferences

CAPACITY up to 1800 seats or 2000 standing places

FACILITIES cloakroom to be set up in the adjacent internal area, kitchen to be set up in the adjacent courtyard

MAX POWER 140 kW

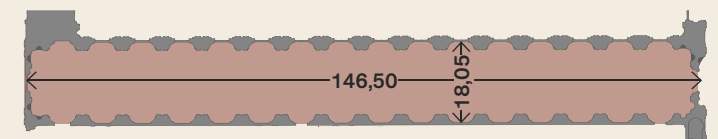

Church of St. Hubert

An eighteenth-century work by the baroque genius of Filippo Juvarra, the interiors act as a spectacular backdrop with light effects and architectural reliefs of great value.



EVENTS	presentations, conferences, aperitifs, gala dinners, concerts, shows, film sets and photo shoots
CAPACITY	up to 300 seats or 450 standing places
FACILITIES	attended cloakroom in the basement
MAX POWER	35 kW, three-phase

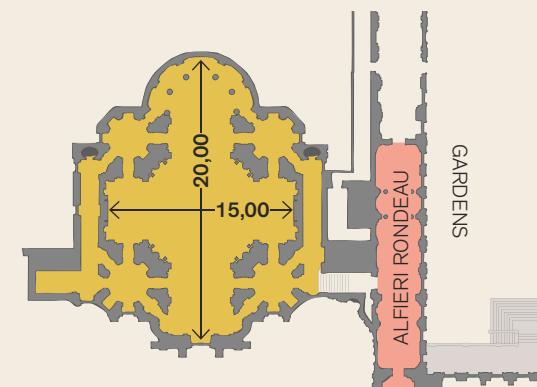

The Gardens

- 6** Court of Honor
- 7** Queen's Terrace
- 8** Rose Garden
- 9** Grand Parterre
- 10** Cascina Medici del Vascello (conference room)
- 11** Cascina Medici del Vascello (multipurpose room)
- 12** Patio dei Giardini

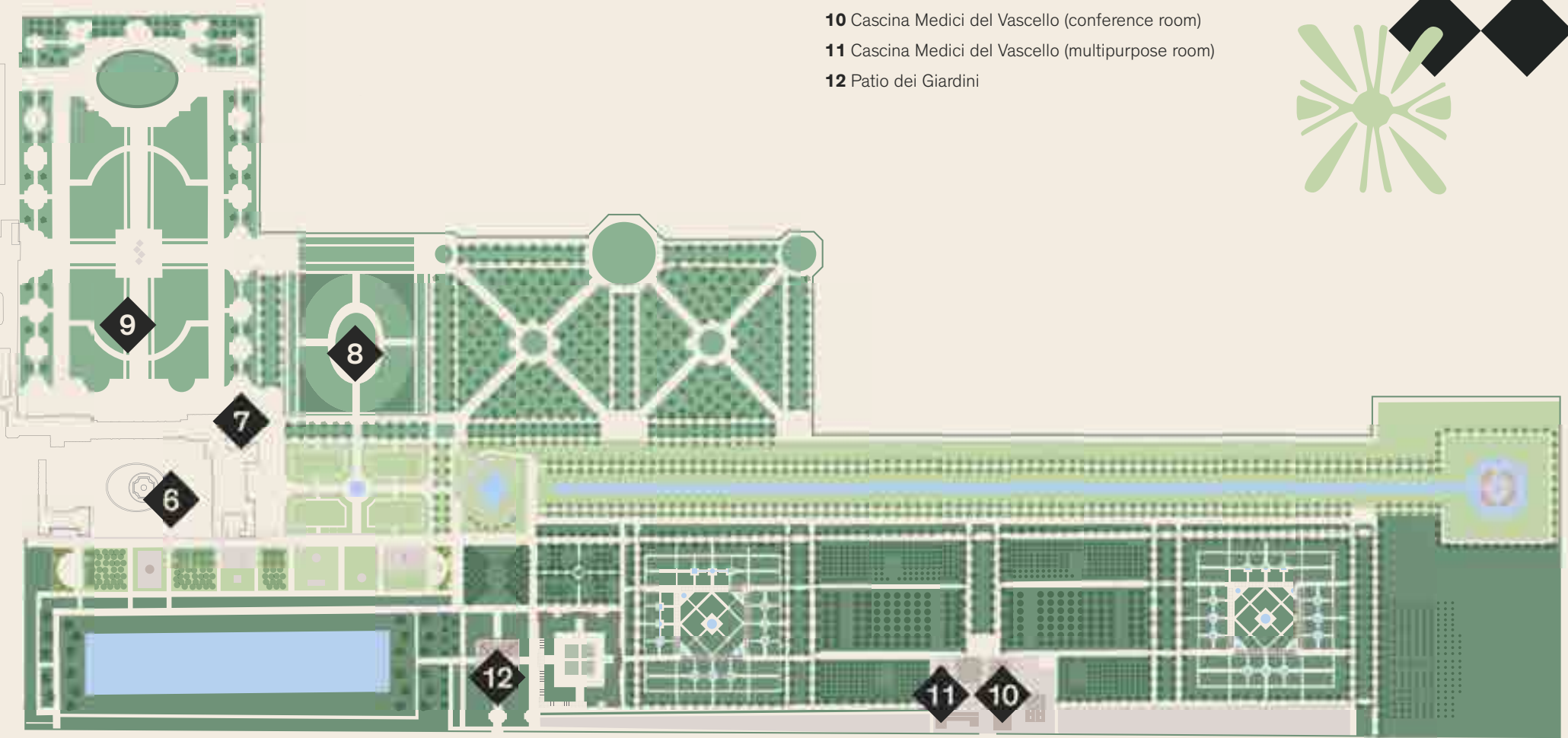
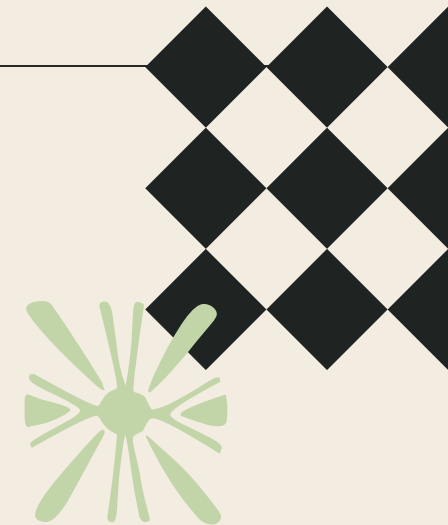

VIALE CARLO EMANUELE II



Cascina Medici del Vascello
Entrance

Court of Honor

The Fountain of the Stag creates stunning scenery of water, lights and music while enriching the charming setting of the Court of Honor

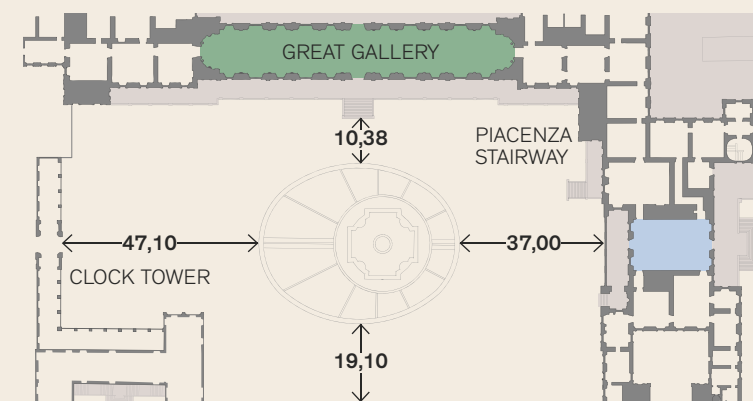

EVENTS	aperitifs, gala dinners 2000 film sets and photo shoots
CAPACITY	up to 2000 people
MAX POWER	18 kW, three-phase (Clock Tower) / 70 kW, three-phase (Piacenza Stairway)



Queen's Terrace



EVENTS	aperitifs, concerts, shows, film sets and photo shoots
CAPACITY	up to 350 people
FACILITIES	equipped kitchen (on the first floor with goods lift)

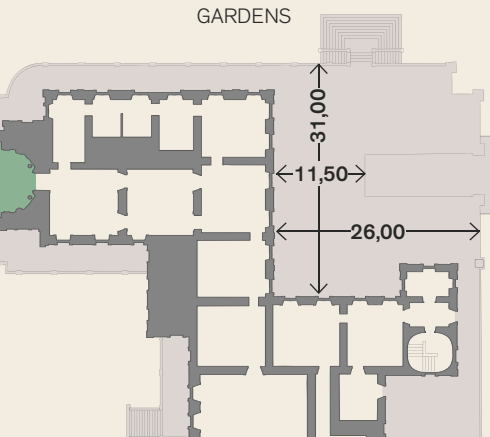

Overlooking the Gardens and an ideal continuation of the Great Gallery, this area is a secluded and extraordinary place, ideal for gatherings and formal events.

Rose Garden



EVENTS	aperitifs, gala dinners, concerts, shows, film sets and photo shoots
CAPACITY	up to 2000 people
MAX POWER	18 kW, three-phase

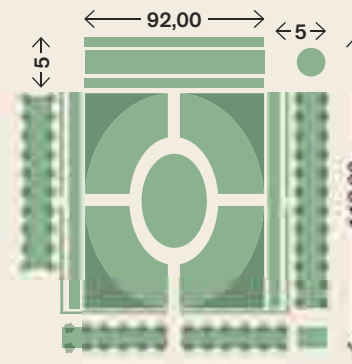

A unique space, immersed in the natural setting of the Upper Park of the Gardens; from here it is possible to admire the stunning architectural complex of Venaria Reale.

Grand Parterre



An imposing and elegant space within Venaria Reale, with the geometric designs of its avenues and its “greenery rooms”, the Grand Parterre is considered one of the emblems of the Reggia.



EVENTS	aperitifs, gala dinners, concerts, shows, film sets and photo shoots
CAPACITY	sector A: up to 180 seats, 1000 standing places sector B: up to 20,000 people
FACILITIES	equipped kitchen (on the first floor with goods lift)
MAX POWER	sector A: 35 kW, three-phase – partially illuminated at night sector B: not illuminated at night

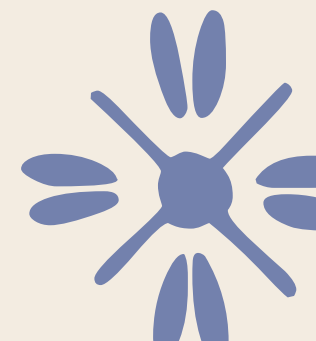
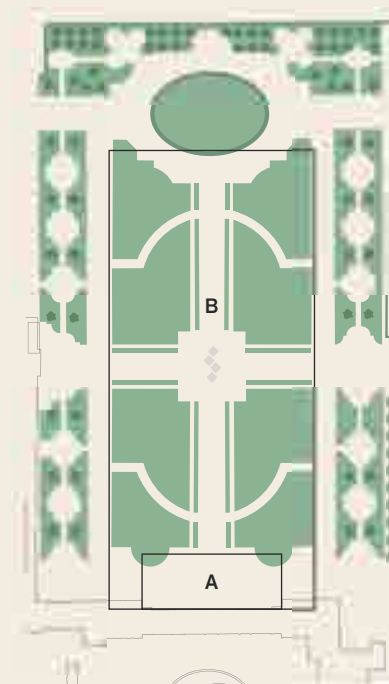

Cascina Medici del Vascello

Conference room

Built in the late nineteenth century, the farmstead is today a charming architectural space surrounded by the Gardens; it also accommodates conference rooms and dining areas.



EVENTS	presentations and conferences
CAPACITY	99 seats
FACILITIES	audio and lighting equipment, screen and projector
MAX POWER	3 kW, single-phase

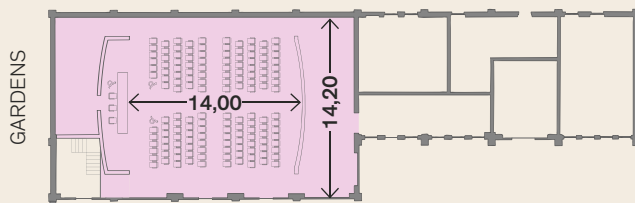

Multipurpose room

The Cascina offers a large multipurpose room overlooking the courtyard which can host team-building events, buffets and aperitifs.



EVENTS	team-building events, presentations, conferences, aperitifs and dinners
CAPACITY	100 seats
FACILITIES	equipped kitchen
MAX POWER	3 kW, single-phase

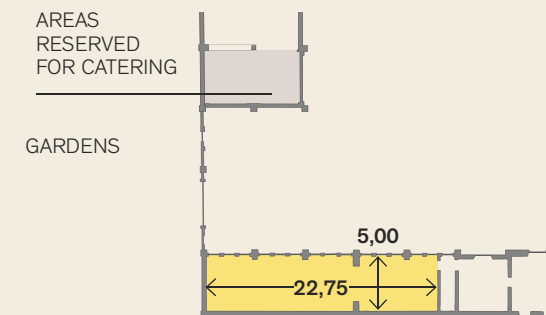

Patio dei Giardini

Immersed in the quiet of the Potager Royal and the Fish-pond, the restaurant is a perfect opportunity to unwind while appreciating Piedmontese cuisine.



EVENTS	aperitifs and gala dinners
CAPACITY	64 indoor seats / 40 outdoor seats mandatory
FACILITIES	mandatory indoor catering
MAX POWER	18 kW, single-phase

GARDENS

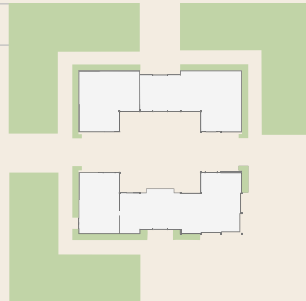

	EVENTS	CAPACITY	FACILITIES	MAX POWER
1. Hall of Diana	presentations, conferences, concerts, shows, film sets, photo shoots, civil weddings	up to 120 seats	attended cloakroom in the basement	6 kW, single-phase
2. Great Gallery	aperitifs, gala dinners, concerts, shows, film sets and photo shoots	up to 600 seats or 850 standing places	equipped kitchen (on the first floor, with goods lift), attended cloakroom in the basement	70 kW, three-phase
3. Alfieri Rondeau	aperitifs, gala dinners, concerts, shows, film sets and photo shoots	up to 180 seats or 350 standing places	equipped kitchen (on the first floor, with goods lift), attended cloakroom in the basement	6 kW, single-phase
4. Citroniera	aperitifs, gala dinners, concerts, shows, film sets, photo shoots, presentations and conferences	up to 1800 seats or 2000 standing places	cloakroom to be set up in the adjacent internal area, kitchen to be set up in the adjacent courtyard	140 kW
5. Church of St. Hubert	presentations, conferences, concerts, shows, film sets and photo shoots	up to 300 seats or 450 standing places	attended cloakroom in the basement	35 kW, three-phase
6. Court of Honor	aperitifs, gala dinners, concerts, shows, film sets and photo shoots	up to 2000 people	attended cloakroom in the basement	18 kW, three-phase (Clock Tower) / 70 kW, three-phase (Piacenza Stairway)
7. Queen's Terrace	aperitifs, concerts, shows, film sets and photo shoots	up to 350 seats	equipped kitchen (on the first floor with goods lift)	
8. Rose Garden	aperitifs, gala dinners, concerts, shows, film sets and photo shoots	up to 2000 people		18 kW, three-phase
9. Grand Parterre	aperitifs, gala dinners, concerts, shows, film sets and photo shoots	SECTOR A up to 180 seats, 1000 standing places SECTOR B up to 20,000 people	equipped kitchen (on the first floor with goods lift)	SECTOR A 35 kW, three-phase – partially illuminated SECTOR B not illuminated
10. Cascina Medici Conference room	presentations and conferences	99 seats	audio and lighting equipment, screen and projector	3 kW, single-phase
11. Cascina Medici Multipurpose room	team-building events, presentations, conferences, aperitifs and dinners	100 seats	equipped kitchen	3 kW, single-phase
12. Patio dei Giardini	aperitifs and gala dinners	64 indoor seats 40 outdoor seats mandatory	mandatory indoor catering	18 kW, three-phase

How to get here

Driving distances from the Reggia of Venaria to

- **Milan** 145 km (1:34 h)
- **Milan Malpensa Airport** 135 km (1:19 h)
- **Turin** 15 km (19 min)
- **Turin Caselle Airport** 15 km (15 min)

Connections from the centre of Turin

- **GTT bus:** lines 72, 11
- **GTT train:** Turin Dora-Ceres line, Venaria stop, viale Roma
- **Special GTT bus line “Venaria Express”** (runs until 8 pm)

Info: GTT: 800-019-152 (toll-free call from Italy) – www.comune.torino.it/gtt

- **By car:** northern ring road of Turin

*Venaria Reale exit: Reggia and Gardens entrance, Piazza della Repubblica.
Savonera exit: Juvarra Stables entrance, Via don Sapino.*



Facilities and accessibility

- **Parking**
- **WiFi**
- **Cleaning service**
- **Resident staff**
- **Firefighting team**
- **Access for disabled people**
- **Private guided tours** of the Reggia and the exhibitions available upon request
- **“Water Theatre” show** at the Fountain of the Stag available upon request
- **Tour of the Gardens aboard the train “La freccia di Diana”** available upon request
- **Bookshop**
- **Cafeteria and restaurants**

Set-up and dismantling times

- **Monday** (closed to the public)
set-up: to be agreed
dismantling: before 3:00 am of the day following the event
- **Tuesday to Friday**
set-up: from 5:00 pm (closing time to the public)
dismantling: before 3:00 am of the day following the event
- **Saturday, Sunday and holidays**
set-up: from 6:30 pm (closing time to the public)
dismantling: before 3:00 am of the day following the event

For information and quotations

ilmiospazio@lavenariareale.it



La Venaria Reale

Consorzio delle Residenze Reali Sabaude
Piazza della Repubblica 4
10078 Venaria Reale (Torino) – Italy
Tel. +39 011 4992333

ilmiospazio@lavenariareale.it

lavenaria.it